

New Style Ball Valve

新型球阀



手动焊接新型球阀
Manual Welded
New Style Ball Valve



手动螺纹新型球阀
Manual Threaded
New Style Ball Valve



手动快装新型球阀
Manual Clamped
New Style Ball Valve

应用:

主要应用于食品、饮料、酿酒、生物制药、化工等领域

设计特点:

- 有独特的花纹表面金属光泽好，并采用锻造式的（在高温下挤压成型）工艺，结构分子比较紧密，强度高，更结实耐用。
- 结构长度紧凑，采用 180°开关设计，拥有更优越的空间。
- 三段式，两头可拆卸，易于拆卸检测，易于清洗。
- 全通路，介质通过速度均匀，受压均匀。
- 连接方式：快装、焊接、螺纹、法兰
- 物料接触部位材质为 304/316L，其他部位 304。
- 密封圈材质：PTFE，符合 FDA117.2600
- 尺寸：1/2"-4" / DN15-DN100
- 标准：3A、DIN、SMS、IDF、RJT、BPE、ISO

Applications:

It is widely used in food, beverage, beer, biopharmaceutical, chemical industry and so on.

Design Features:

- There are special texture patterns on the surface, and the forging (extrusion molding at high temperature) process is adopted to make the structural molecules more compact, high strength and more durable.
- Compact structure, 180 ° switch design, saving space
- Three-stage, detachable at both ends, easy to disassemble and test, easy to clean.
- Full bore, The medium can pass through uniformly and the stress is uniform
- Connection Type: Clamp, Weld, Thread, Flange
- The material contact part is 304 / 316L, and the other parts are 304
- Seal Material: PTFE, it is according to FDA117.2600
- Size: 1/2"-4" / DN15-DN100
- Standard: 3A, DIN, SMS, IDF, RJT, BPE, ISO

New Style Ball Valve

新型球阀

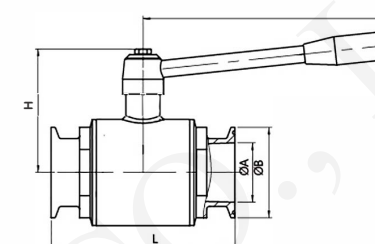

JOV-BHM2002-22

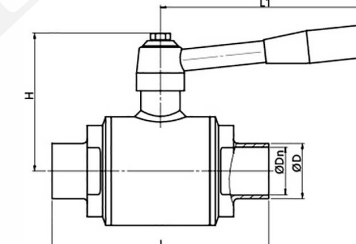

JOV-BHM2002-11

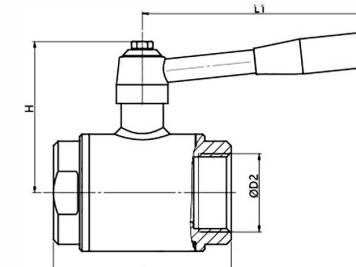

JOV-BHM2002-33N

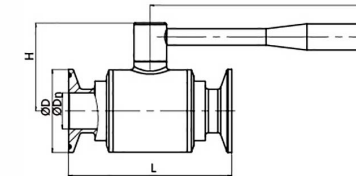

JOV-BHM2003-22

新型球阀
New Style Ball Valve

快装
Clamp

3A

3Size	ØA	ØB	L	H	E
1/2"	9.4	25.2	75	49	97
3/4"	15.8	25.2	100	53	97
1"	22.1	50.5	100	65	116
1.25"	28.5	50.5	100	65	116
1.5"	35	50.5	116	72	140
1.75"	42	64	130	87	175
2"	48	64	136	93	175
2.5"	60.3	77.5	165	103	200
3"	73	91	172	110	200

新型球阀
New Style Ball Valve

焊接
Weld

3A

Size	ØDn	ØD	ØD1	L	L1	H
1/2"	9.4	12.7	25.2	75	97	49
3/4"	15.8	19.1	25.2	100	97	53
1"	22.1	25.4	50.5	100	116	64
1.25"	28.5	31.8	50.5	100	116	64
1.5"	34.8	38.1	50.5	116	140	71
2"	47.5	50.8	64	136	175	93
2.5"	60.2	63.5	77.5	165	200	103
3"	72.9	76.2	91	172	200	110
4"	97.4	101.6	119	260	333	151

新型球阀
New Style Ball Valve

内螺纹
Female Thread

Size	G	ØD 2 NP T	BSPT	L	L1	H
1/2"	1/2"	1/2"	1/2"	75.5	97	49
3/4"	3/4"	3/4"	3/4"	75.5	97	53
1"	1"	1"	1"	75.5	116	64
1.25"	1.25"	1.25"	1.25"	94.5	116	64
1.5"	1.5"	1.5"	1.5"	108	140	71
2"	2"	2"	2"	116	175	93
2.5"	2.5"	2.5"	2.5"	136	200	103
3"	3"	3"	3"	165	200	110
4"	4"	4"	4"	180	333	151

直通手动球阀 B 型
New Style Ball Valve B-Type

快装
Clamp

3A

Size	ØDn	ØD	L	L1	H
1/2"	9.4	25.2	75	97	43.5
3/4"	15.8	25.2	100	97	46.5
1.0"	22.1	50.5	100	136	53.5
1.5"	35	50.5	116	136	60.5
2.0"	48	64	136	177	72