

# Direct Way Ball Valve

## 直通球阀

# Direct Way Ball Valve

## 直通球阀



手动快装直通球阀  
Manual Clamped  
Direct Way Ball Valve



气动快装直通球阀  
Pneumatic Clamped  
Direct Way Ball Valve



气动 (不锈钢) 快装直通球阀  
Electric (Stainless Steel)  
Clamped Direct Way Ball Valve

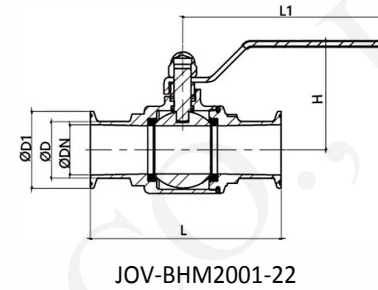

JOV-BHM2001-22

手动直通球阀 Manual Direct Way Ball Valve						焊接 / 快装 Weld/Clamp	3A
Size	ØDn	ØD	ØD1	L	L1	H	
1/2"	9.4	12.7	25.2	75	111	60	
3/4"	15.8	19.1	25.2	100	114	62	
1"	22.1	25.4	50.5	120	140	65	
1.25"	28.5	31.8	50.5	130	140	72	
1.5"	34.8	38.1	50.5	140	160	79	
2"	47.5	50.8	64	164	175	94	
2.5"	60.2	63.5	77.5	189	230	104	
3"	72.9	76.2	91	212	246	116	
4"	97.4	101.6	119	260	333	151	

### 应用:

卫生级直通球阀采用标准电子抛光, 光滑表面确保清洁, 无介质积存区域, 不会产生潜在的污染。快速拆装阀, 使阀门打开和维修快捷容易, 使过程停机时间缩短。广泛应用于如食品、制药、化妆品、洁净蒸汽、酒类、饮料、生化工业过程控制场合。

### Applications:

Sanitary direct way ball valve adopts standard electronic polishing, smooth surface to ensure cleanliness, no media accumulation area, no potential pollution. The valve can be assembled and disassembled quickly and easily to open and maintain the valve, and the shutdown time of the process can be shortened. It is widely used in food, pharmaceutical, cosmetics, clean steam, beer, beverage, biochemical industrial process control occasions.

### 设计特点:

- 流体阻力小,
- 球阀的结构简单、体积小、重量轻, 易维修
- 操作方便, 开闭迅速, 从全开到全关只要旋转 90°。
- 在全开或全闭时, 球体和阀座的密封面与介质隔离, 介质通过时, 不会引起阀门密封面的侵蚀。
- 规格: 1/2"-4"、Ø12.7—Ø101.6
- 连接: 快装、焊接、螺纹、法兰等。
- 驱动方式: 手动、气动、电动。
- 标准: ISO、DIN、IDF、SMS、3A 等
- 质量: 产品内外用高档抛光设备处理, 达到表面精密要求
- 工作压力: 0-10Bar
- 工作温度: -40°C ~ +150°C

### Design Features:

- Small fluid resistance
- Simple structure, small volume, light weight and easy maintenance
- Easy to operate, open and close rapidly, only need to rotate 90° from fully open to fully closed.
- When the valve is fully open or fully closed, the sealing surface of the ball and the valve seat is isolated from the medium and the medium will not cause corrosion to the valve sealing surface when the medium passes.
- Size: 1/2" -4" . Ø12.7—Ø101.6
- Connection : Clamp, Weld, Thread, Flange ect.
- Driving mode: Manual , Pneumatic, Electric
- Standard: ISO、DIN、IDF、SMS、3A etc.
- Quality: The inside and outside of the product are treated with high-end polishing equipment to meet the surface precision requirements
- Working Pressure:0-10Bar
- Working temperature :-40°C ~ +150°C

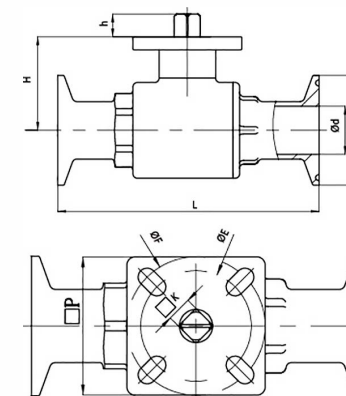

JOV-BHPA2001-22

直通高平台球阀 Direct Way High Platform Ball Valve										焊接 / 快装 Weld/Clamp	3A
Size	Ød	ØD	ØE	ØF	L	H	h	K	P	扭矩 N.M	
3/4"	16.5	50.5	40	50	100	34	9	9	50×50	6	
1"	22.1	50.5	40	50	120	43	10.5	9	50×50	9	
1.25"	28.5	50.5	40	50	130	47	10	9	50×50	14	
1.5"	34.8	50.5	40	50	140	53	10	9	50×50	22	
1.75"	42	64	40	50	158	60	12	11	50×50	55	
2"	47.5	64	40	50	163	64	12	11	50×50	55	
2.5"	60.2	77.5	50	70	190	75	16.5	14	64×64	60	
3"	72.9	91	50	70	211	88.5	18	14	64×64	105	
3.5"	85	106	70	102	232	100	18	17	90×90	130	
4"	97.4	119	70	102	260	125	18.5	17	90×90	165	

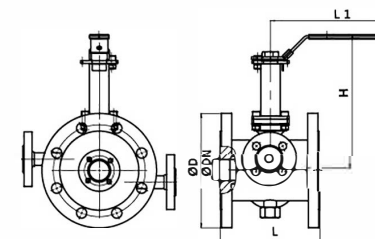

JOV-BHM2015-44

手动高平台保温球阀 Manual High Platform Jacketed Ball Valve						法兰 Flange	
Size	ØDn	ØD	L	L1	H		
DN20	19	150	130	130	178		
DN25	25	165	140	170	207		
DN40	40	200	173	217	237		
DN50	50	200	203	217	247		
DN80	80	250	240	326	282		
DN100	98	285	267	326	300		